



2024

Providing Sustainable Housing Solutions For The Unhoused

WHY ROKIT HOMES?

The need to supply affordable, sustainable, and environmentally friendly housing has never been greater.

Whether for disaster area resettlement, medical buildings, or new areas to combat congested living areas placing a strain on local resources, ROKIT Homes' integrated modular compact housing provides the perfect high quality, affordable solution.

- 🕒 **Easy to transport:** Most Models are Flat packed.
- 🕒 **Quick to assemble:** 2+ hour assembly time.
- 🕒 **High quality:** Life expectancy **25 years**.
- 🕒 **Strong:** Welded structure with galvanized steel.
- 🕒 **Environmentally friendly:** Uses no concrete, and less than 50% of the energy needed to build the temporary housing solutions.
- 🕒 **Resistant against Flooding, Cyclones, and Hurricane Force Winds.**
- 🕒 **One of a kind Proposition:** Contact us to find out how we can provide our homes at no upfront cost!



ROKIT 1

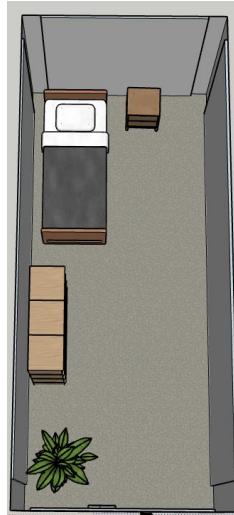

Example Layout

Specification:

🕒 **Dimensions:**

- Length: 5.9m / 19.35ft
- Width: 2.5m / 8.2ft
- Height: 2.9m / 9.5ft
- Internal Area: 13.3 sqm / 143 sqft
- Weight 1,800KG / 3,968lbs

🕒 **Framework:** Aluminum-zinc-plated colored steel plate, Glass wool insulation board, thickness 75mm flame retardant grade A

🕒 **Manufacturing lead time:** In Stock

🕒 **Assembly Time:** 1-5 Hours (2 People)

🕒 **Rigid or Foldable Assembly Available**

🕒 **Each Shipping Container Holds 10 Units**

🕒 **Prewired with 2 LED lights and 3 sockets**



Scan QR Code for Foldable Assembly Video

ROKIT 2

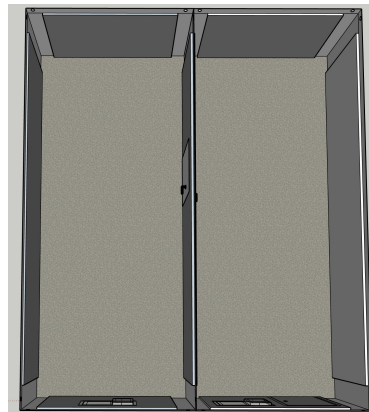

Specification:

🕒 Dimensions:

- Length: 5900mm / 19.35ft
- Width: 5000mm / 16.4ft
- Height: 2896mm / 9.5ft
- Internal Area: 26.6 sqm / 286 sqft
- Weight 3600KG / 7936lbs

🕒 **Framework:** Aluminum-zinc-plated colored steel plate, Glass wool insulation board, thickness 75mm flame retardant grade A

🕒 **Manufacturing lead time:** In Stock

🕒 **Assembly Time:** 2-10 Hours (2 People)

🕒 **Each Shipping Container Holds 5 Units**

🕒 **Prewired with 4 LED lights and 6 sockets**

ROKiT 3

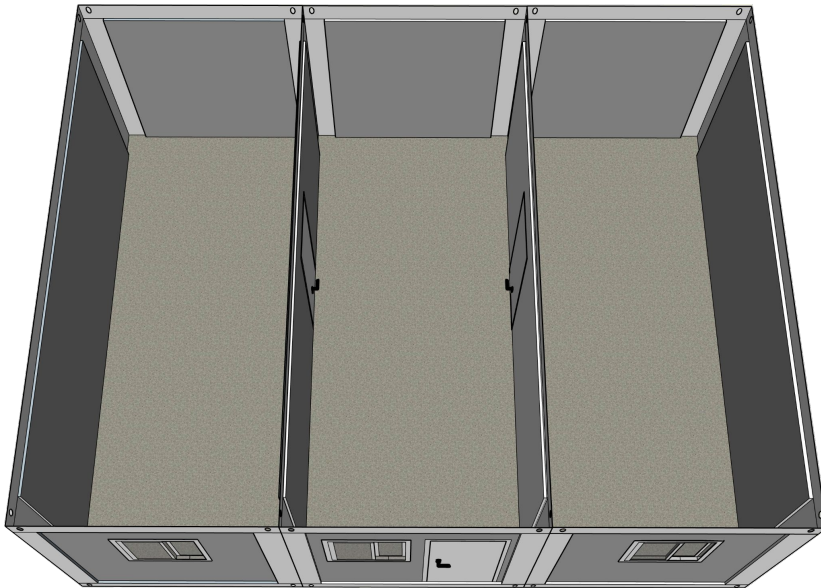

Specification:

🕒 Dimensions:

- Length: 5900mm / 19.35ft
- Width: 7500mm / 24.6ft
- Height: 2896mm / 9.5ft
- Internal Area: 39.9 sqm / 429 sqft
- Weight 5400KG / 11,904lbs

🕒 **Framework:** Aluminum-zinc-plated colored steel plate, Glass wool insulation board, thickness 75mm flame retardant grade A

🕒 **Manufacturing lead time:** In Stock

🕒 **Assembly Time:** 3-15 Hours (2 People)

🕒 **Each Shipping Container Holds 3 Units**

🕒 **Prewired with 6 LED lights and 9 sockets**

ROKiT 4



Specification:

🕒 Dimensions:

- ◆ Length: 5900mm / 19.35ft
- ◆ Width: 6300mm / 20.67ft
- ◆ Height: 2480mm / 8.14ft
- ◆ Internal Area: 34 sqm / 372 sqft
- ◆ Weight: 4500KG / 10141lbs

🕒 **Framework:** Aluminum-zinc-plated colored steel plate, Glass wool insulation board, thickness 75mm flame retardant grade A

🕒 **Manufacturing lead time:** In Stock

🕒 **Assembly Time:** 1-2 Hours (2 People)

🕒 **Each Shipping Container Holds 2 Units**

🕒 **Prewired with 6 LED lights and 6 sockets**



Scan QR Code for Assembly Video

ROKiT 4 Slim

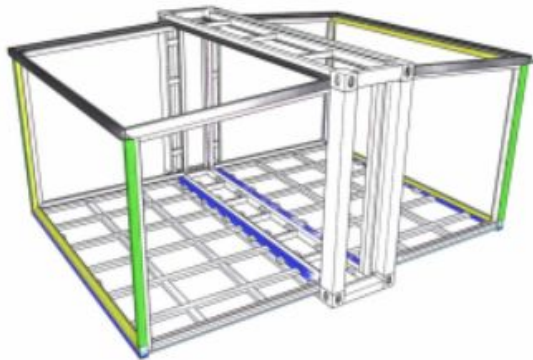

Specification:

🕒 **Dimensions:**

- ◆ Length: 5.9m / 19.35ft
- ◆ Width: 4.8m / 15.75ft
- ◆ Height: 2.5m / 8.14ft
- ◆ Internal Area: 25.3 sqm / 272 sqft
- ◆ Weight 2,100KG / 4,629lbs

- ### 🕒 **Framework:** Aluminum-zinc-plated colored steel plate, Glass wool insulation board, thickness 75mm flame retardant grade A

- ### 🕒 **Manufacturing lead time:** In Stock

- ### 🕒 **Assembly Time:** 1-2 Hours (2 People)

- ### 🕒 **Each Shipping Container Holds 6 Units**

- ### 🕒 **Prewired with 5 LED lights and 5 sockets**

Multi Unit Housing Structure



Specification:

🕒 **Dimensions:**

- ◆ Length: 5.9m / 19.35ft
- ◆ Width: 4.72m / 15.486ft
- ◆ Height: 5.8m / 19ft
- ◆ Internal Area: 212.8 sqm / 2,288 sqft
- ◆ Weight 28,800KG / 63,588lbs

- ### 🕒 **Framework:** Aluminum-zinc-plated colored steel plate, Glass wool insulation board, thickness 75mm flame retardant grade A

- ### 🕒 **Manufacturing lead time:** In Stock

- ### 🕒 **Configurable:** Can be customized based on the number of units required

Community Restrooms & Showers

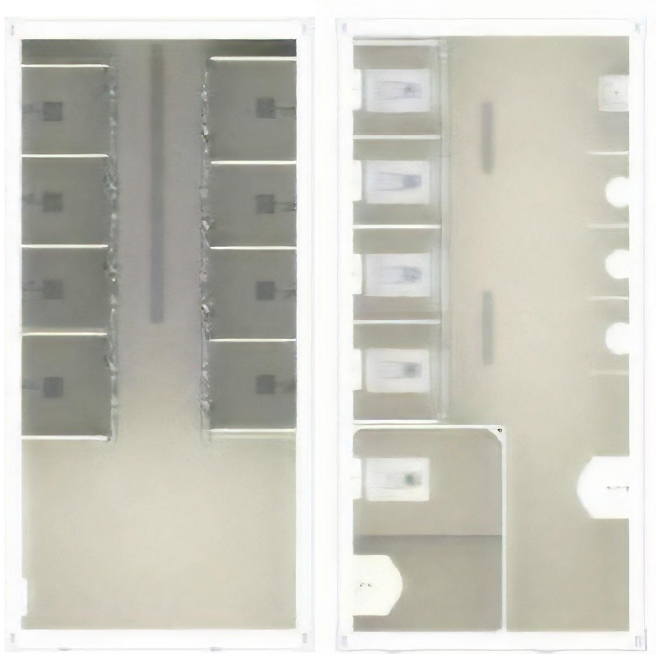

Communal
Shower room

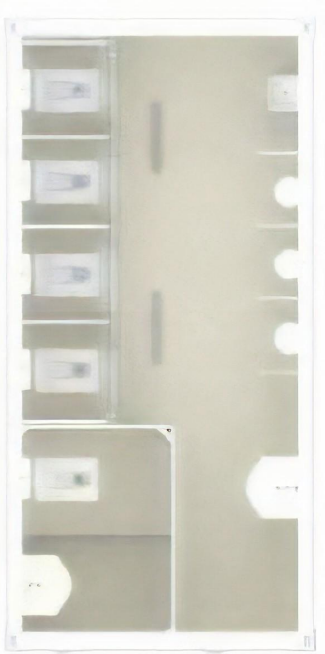

Communal
Restroom



Restroom
Interior



Shower Room
Interior

Specification:

🕒 Dimensions:

- ◆ Length: 5.9m / 19.35ft
- ◆ Width: 2.5m / 8.2ft
- ◆ Height: 2.9m / 9.5ft

🕒 **Framework:** Aluminum-zinc-plated colored steel plate, Glass wool insulation board, thickness 75mm flame retardant grade A

🕒 **Manufacturing lead time:** In Stock

🕒 **Assembly Time:** 2 Hours (2 People)

🕒 **Each Shipping Container Holds 3 Units**

Building Services

At ROKiT Homes we are dedicated to ensuring that your team is fully equipped with the necessary skills and knowledge required for the assembly of any ROKiT home. To achieve this, we offer an extensive training program that covers all aspects of construction and assembly processes. Our program is designed to empower your team with the expertise needed to successfully complete any project, ensuring they are well-prepared to tackle the challenges of assembling ROKiT homes efficiently and effectively.

Additionally, we understand that certain projects may require a more hands-on approach. For such instances, we are pleased to offer the services of our highly skilled construction engineers. Our team of experts can be deployed to your project site anywhere in the world. We provide this service at cost price, ensuring that you have access to top-tier construction engineering support without the burden of excessive expenses. Whether you choose to empower your team through comprehensive training or opt for the direct involvement of our construction engineers, ROKiT Homes Building Services is here to support your endeavors every step of the way.

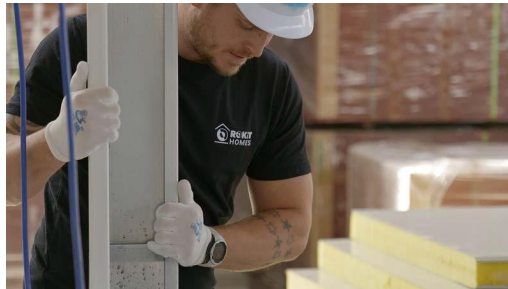

Our Factory

Affordable, high-quality homes that are reusable and customizable for quick and easy installation. Produced at our state-of-the-art facilities with cutting-edge technology, our production scale is unmatched in the industry.



Virtual Tour

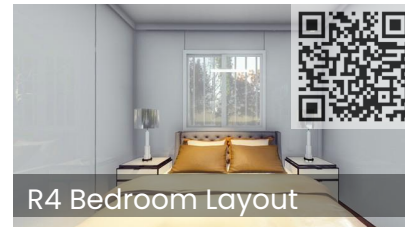
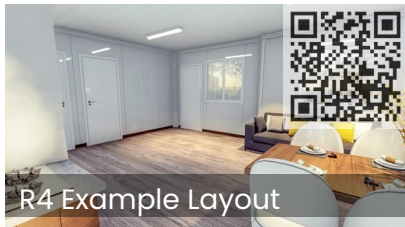
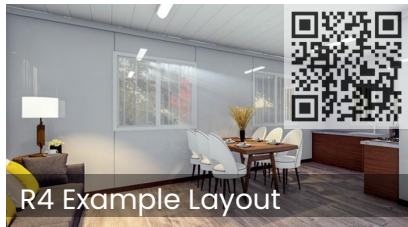
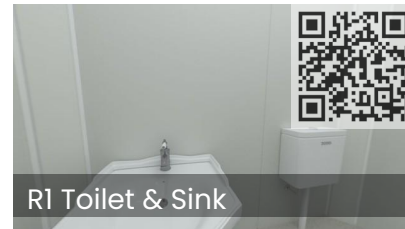
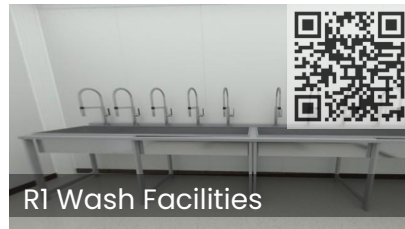
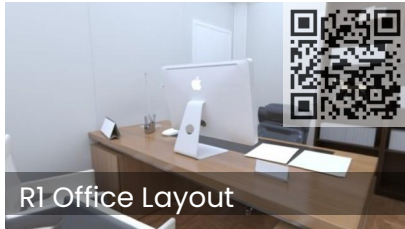

More Videos

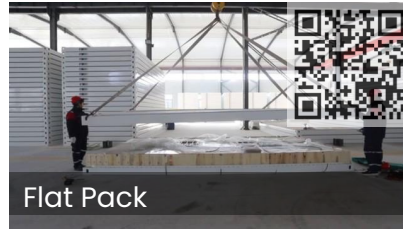

More Images



Thank You

For more information, please contact
info@ROKiTHomes.com

