



2024

WHY ROKiT HOMES?

The need to supply affordable, sustainable, and environmentally friendly housing has never been greater.

Whether for disaster area resettlement, medical buildings, or new areas to combat congested living areas placing a strain on local resources, ROKiT Homes' integrated modular compact housing provides the perfect high quality, affordable solution.

- 🕒 **Easy to transport:** Flat packed.
- 🕒 **Quick to assemble:** 2 hour assembly time.
- 🕒 **High quality:** Life expectancy 25 years.
- 🕒 **Strong:** Welded structure with galvanised steel.
- 🕒 **Modular:** Design allows individual units to be joined and stacked to build larger units.
- 🕒 **Environmentally friendly:** Uses no concrete, and less than 50% of the energy needed to build the temporary housing solutions.
- 🕒 Resistant against Flooding, Cyclones, and Hurricane Force Winds.



ROKiT 1



ROKiT 4



ROKiT 5

ROKiT 1



Available in a variety of colors

Specification:

🕒 **Dimensions:**

- Length: 5900mm / 19.35ft
- Width: 2500mm / 8.2ft
- Height: 2896mm / 9.5ft
- Internal Area: 13.3 sqm / 143 sqft
- Weight 1800KG / 3968lbs

🕒 **Framework:** Aluminum-zinc-plated colored steel plate, Glass wool insulation board, thickness 75mm flame retardant grade A

🕒 **Can come in a rigid or foldable assembly**

🕒 **Manufacturing lead time:** In Stock

🕒 **Assembly Time:** 2 Hours (2 People)



Scan QR Code for Foldable Assembly Video

ROKiT 2



Available in a variety of colors

Specification:

🕒 Dimensions:

- Length: 5900mm / 19.35ft
- Width: 2500mm / 8.2ft
- Height: 2896mm / 9.5ft
- Internal Area: 13.3 sqm / 143 sqft
- Weight 1800KG / 3968lbs

🕒 **Framework:** Aluminum-zinc-plated colored steel plate, Glass wool insulation board, thickness 75mm flame retardant grade A

🕒 **Includes Food Preparation Area**

🕒 **Can come in a rigid or foldable assembly**

🕒 **Manufacturing lead time:** In Stock

🕒 **Assembly Time:** 2 Hours (2 People)



Scan QR Code for Foldable Assembly Video

ROKiT 3



Available in a variety of colors

Specification:

🕒 **Dimensions:**

- Length: 5900mm / 19.35ft
- Width: 2500mm / 8.2ft
- Height: 2896mm / 9.5ft
- Internal Area: 13.3 sqm / 143 sqft
- Weight 1800KG / 3968lbs

🕒 **Framework:** Aluminum-zinc-plated colored steel plate, Glass wool insulation board, thickness 75mm flame retardant grade A

🕒 **Floor to ceiling glass window**

🕒 **Manufacturing lead time:** In Stock

🕒 **Assembly Time:** 2 Hours (2 People)

ROKiT 4



Specification:

🕒 Dimensions:

- Length: 5900mm / 19.35ft
- Width: 6300mm / 20.67ft
- Height: 2480mm / 8.14ft
- Internal Area: 34 sqm / 372 sqft
- Weight: 4500KG / 10141lbs

🕒 Framework:

- Top frame main beam
- Bottom frame main beam
- Flip Bottom Frame
- Top Insulation
- Bottom Insulation
- Steel doors, hollow windows, interior partition wall panels

🕒 Manufacturing lead time: In Stock



Scan QR Code for Assembly Video

ROKiT 5



Specification:

🕒 **Dimensions:**

- Length: 5900mm / 19.35ft
- Width: 6000mm / 19.69ft
- Height: 5792mm / 19ft
- Internal Area: 40 sqm / 429 sqft
- Balcony Area: 13.3 sqm / 143 sqft (excluding stairs)
- Weight: 7900KG / 17417lbs

🕒 **Framework:** Aluminum-zinc-plated colored steel plate, Glass wool insulation board, thickness 75mm flame retardant grade A

🕒 **Premium Glass walls and Glass Balcony**

Multi Unit Housing Structure



Specification:

🕒 **Dimensions:**

- Length: 5900mm / 19.35ft
- Width: 47,200mm / 154.86ft
- Height: 5792mm / 19ft
- Internal Area: 212.8 sqm / 2288 sqft
- Weight 28800KG / 63,588lbs

🕒 **Framework:** Aluminum-zinc-plated colored steel plate, Glass wool insulation board, thickness 75mm flame retardant grade A

🕒 **Manufacturing lead time:** In Stock

🕒 **Configurable:** Can be customized based on the number of units required

Community Restrooms and Showers



Communal
Shower room



Communal
Restroom



Restroom
Interior



Shower Room
Interior

Specification:

🕒 Dimensions:

- Length: 5900mm / 19.35ft
- Width: 2500mm / 8.2ft
- Height: 2896mm / 9.5ft

🕒 **Framework:** Aluminum-zinc-plated colored steel plate, Glass wool insulation board, thickness 75mm flame retardant grade A

🕒 **Manufacturing lead time:** In Stock

🕒 **Assembly Time:** 2 Hours (2 People)

Building Services

At ROKiT Homes we are dedicated to ensuring that your team is fully equipped with the necessary skills and knowledge required for the assembly of any ROKiT home. To achieve this, we offer an extensive training program that covers all aspects of construction and assembly processes. Our program is designed to empower your team with the expertise needed to successfully complete any project, ensuring they are well-prepared to tackle the challenges of assembling ROKiT homes efficiently and effectively.

Additionally, we understand that certain projects may require a more hands-on approach. For such instances, we are pleased to offer the services of our highly skilled construction engineers. Our team of experts can be deployed to your project site anywhere in the world. We provide this service at cost price, ensuring that you have access to top-tier construction engineering support without the burden of excessive expenses. Whether you choose to empower your team through comprehensive training or opt for the direct involvement of our construction engineers, ROKiT Homes Building Services is here to support your endeavors every step of the way.

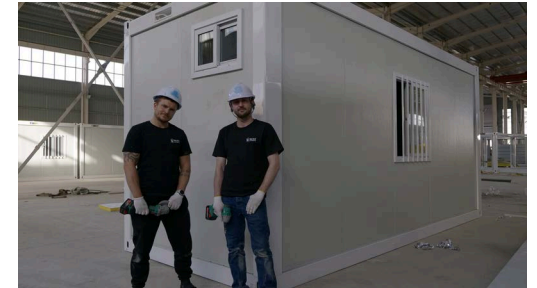

Our Factory

Affordable, high-quality homes that are reusable and customizable for quick and easy installation. Produced at our state-of-the-art facilities with cutting-edge technology, our production scale is unmatched in the industry.



Virtual Tour

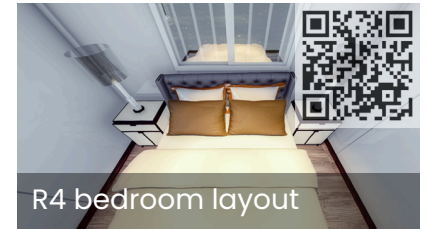
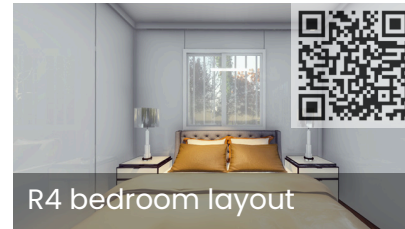
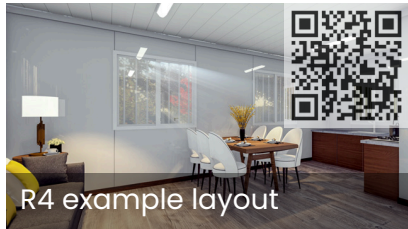
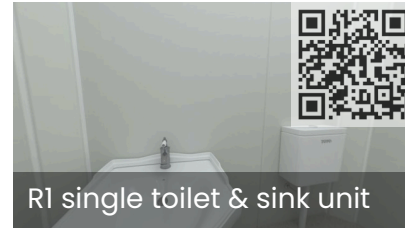
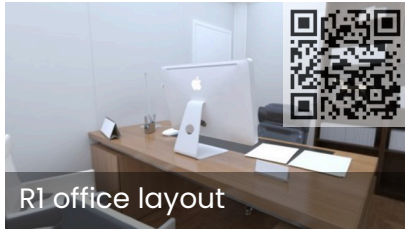
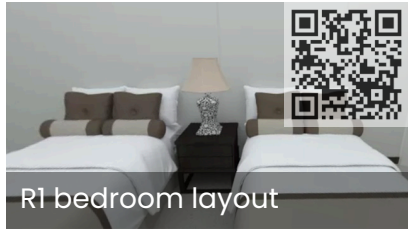

More Videos

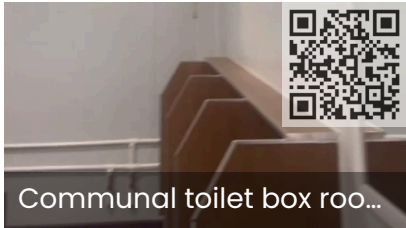
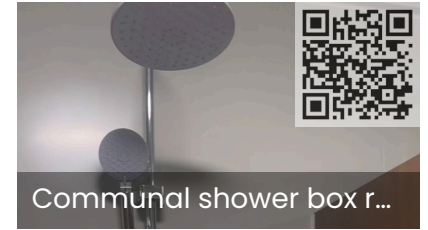

More Images

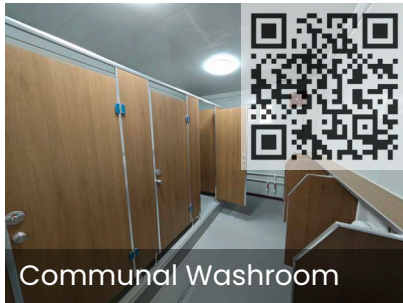
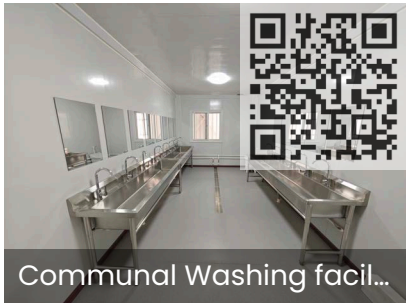

Thank You

For more information, please contact
homes@rokit.com

